

Shelf 802.03.100

- shelf with integrated support rails
- non-breakable shelf with raised edge
- used for support, to stand up independently and to hold accessories
- easy to clean surface
- the mirror can be mounted with the shelf in the centre
- 710 mm wide, 220 mm high, 151 mm deep
- support rail tilt adjustable in positions 0° and 30°
- easy and enclosed assembly with the included corrosion-free HEWI fixing material
- shelf surface in matt white synthetic material
- frame in chrome-plated aluminium with powder coated, matt features
- grips in tactile polyamide, in the five HEWI colours 98 (signal white), 99 (pure white), 92 (anthracite grey), 97 (light grey) and 33 (ruby red)

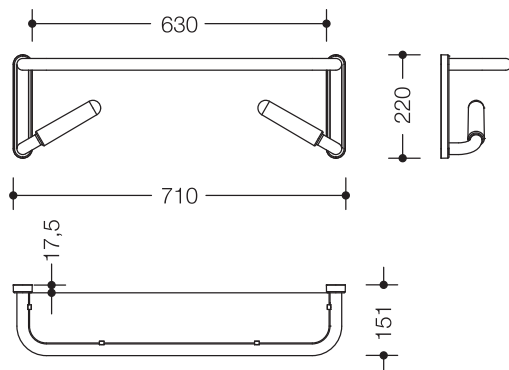

Dimensions in mm



Surfaces/Colours

chrome	matt	33	92	97	98	99
--------	------	----	----	----	----	----

LifeSystem

Alternative surface/colour

chrome	white	98	99
--------	-------	----	----

LifeSystem White Edition

Technical information subject to alteration, 16.01.2013

HEWI Heinrich Wilke GmbH
Postfach 1260
D-34442 Bad Arolsen

Telefon: +49 5691 82-366
Telefax: +49 5691 82-99366
international@hewi.com
www.hewi.com

HEWI (UK) Limited
Scimitar Close
Gillingham Business Park
Gillingham Kent ME8 0RM

Phone +44 1634 377 688
Fax + 44 1634 370612
info@hewi.co.uk
www.hewi.co.uk