

INTAKE

Design: Andrea Morgante

ottone stampato a caldo - hot stamped brass

FINITURE / FINISHES



IN14P - OC



OC

Cromo
Chrome



ORS

Rosso
Red



OBN

Bianco
White



OGA

Giallo
Yellow



ONO

Nero
Black

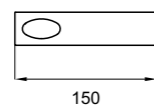

150



50

IN14
IN14P
IN14Y
IN14T

34

INTAKE

Design: Andrea Morgante



DI MANO IN MANO

