

## TE 640 3D A8 Energy

with permanent energy transfer for unrebated high performance heavy-duty doors with claddings of up to 8 mm

### hinge

#### Technical details

load capacity	160,0 kg
overall length	240,0 mm
width (door)	32,0/37,0 mm
width (frame)	32,0/37,0 mm
cutter diameter	24,0 mm
opening angle	180° degree
no. of wires	16 No. of wires
wire cross section	0,14 mm
max. voltage	60 V
max. current	0,8 A

#### descriptive text

SIMONSWERK TECTUS hinge TE 640 3D A8 Energy with integrated and permanent energy transfer for doors with claddings of up to 8 mm. Completely concealed for unrebated, heavy-duty doors with timber, steel and aluminium frames. With comfortable 3D adjustment, load capacity up to 160 kg, opening angle up to 180°, overall length 240 mm, right hand and left hand applicable, maintenance-free slide bearings, three-dimensionally adjustable: side +/- 3,0 mm, height +/- 3,0 mm, compression +/- 1,0 mm. Finish...

#### Note

The load capacity mentioned above refers to the use of 2 hinges per door leaf (1 x 2 m).

#### Scope of supply

Special ribbon cable with plug connection to round cable at both ends. Cable set consists of 2 round cabled both with reverse-polarity-protected connecting socket for the special ribbon cable (2 x round cable 3,0 m), opposite cable ends open.

#### Product features

- completely concealed hinge system
- for timber, steel or aluminium frames
- for unrebated high performance heavy-duty doors
- maintenance-free slide bearings
- with comfortable 3D adjustment (side +/- 3,0 mm, height +/- 3,0 mm, compression +/- 1,0 mm)
- cladding up to 8 mm
- with permanent energy transfer

#### Functional areas

fire resistance, smoke resistance, soundproof und burglar resistance

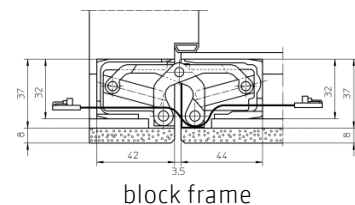
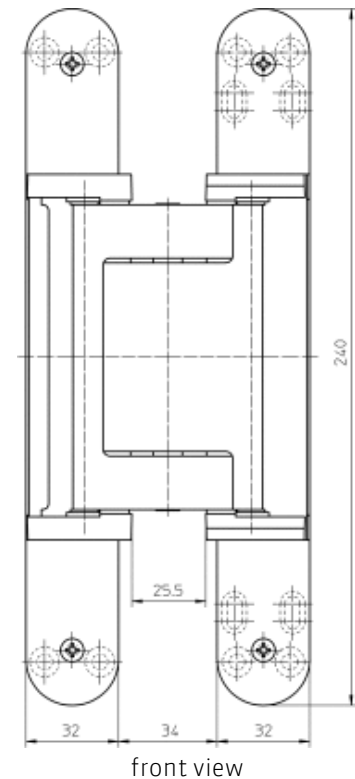
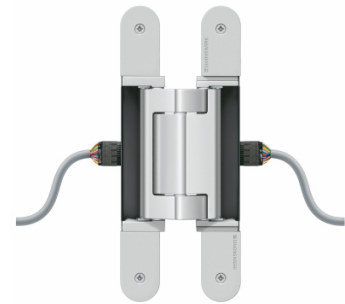

## TE 640 3D A8 Energy

with permanent energy transfer for unrebated high performance heavy-duty doors with claddings of up to 8 mm

### hinge

#### Combination

accessories	cover plate set TECTUS A8 radius
receiver	TE 640 3D FZ/1 TE 640 3D A8 SZ

#### installation tools

universal milling frame	
template 5 250659 5	step 1
template 5 250688 5	step 3 (without cladding)
template 5 250689 5	step 2
template 5 250690 5	step 3
template 5 250939 5	flat line routing energy

#### Items (DIN reference: DIN right and left hand)

<b>finishes(es)</b>	F1-coloured 124
<b>packing unit</b>	pack of 1
<b>item number</b>	5 400626 0 12401
<b>finishes(es)</b>	stainless steel look 126
<b>packing unit</b>	pack of 1
<b>item number</b>	5 400626 0 12601

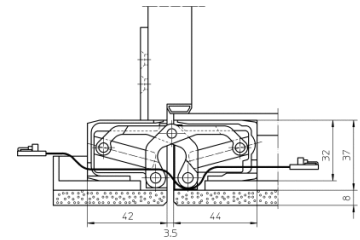

casing frame

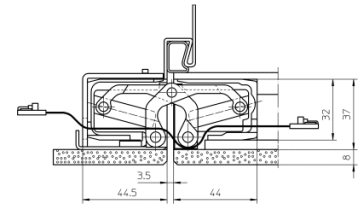

steel frame