

TE 240 3D Energy

with permanent energy transfer for unrebated and rebated flush residential doors

hinge

Technical details

load capacity	40,0 kg
overall length	155,0 mm
width (door)	18,0 mm
width (frame)	21,0 mm
cutter diameter	16,0 mm
opening angle	180° degree
no. of wires	16 No. of wires
wire cross section	0,14 mm
max. voltage	60 V
max. current	0,8 A

descriptive text

SIMONSWERK TECTUS hinge TE 240 3D Energy with integrated and permanent energy transfer. Completely concealed for unrebated and rebated flush doors with timber, steel and aluminium frames. Load capacity up to 40 kg, opening angle up to 180°, overall length 155 mm, right hand and left hand applicable, maintenance-free slide bearings, three-dimensionally adjustable: side +/- 3,0 mm, height +/- 3,0 mm, compression +/- 1,5 mm. Finish...

Note

The load capacity mentioned above refers to the use of 2 hinges per door leaf (1 x 2 m).

Finger protection on the hinge side due to a small gap between door and frame.

Scope of supply

Special ribbon cable with plug connection to round cable at both ends. Cable set consists of 2 round cabled both with reverse-polarity-protected connecting socket for the special ribbon cable (2 x round cable 3,0 m), opposite cable ends open.

Product features

- completely concealed hinge system
- for timber, steel or aluminium frames
- for unrebated and rebated flush residential doors
- maintenance-free slide bearings
- with comfortable 3D adjustment (side +/- 3,0 mm, height +/- 3,0 mm, compression +/- 1,5 mm)
- with permanent energy transfer

Quality marks

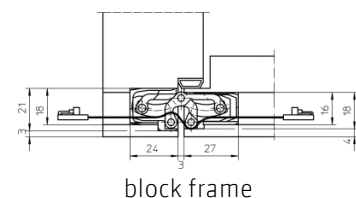
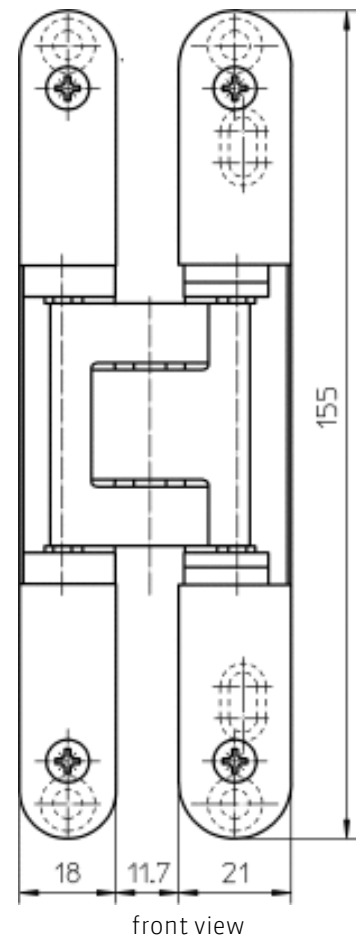
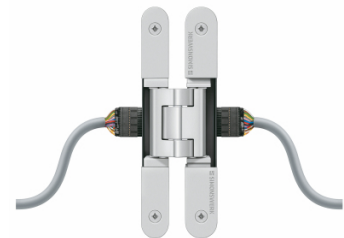

TE 240 3D Energy

with permanent energy transfer for unrebated and rebated flush residential doors

hinge

Combination

receiver	TE 240 3D FZ/1 TE 240 3D SZ
----------	--------------------------------

installation tools

universal milling frame	
template 5 250940 5	flat line routing energy
template 5 250691 6	step 1
template 5 250692 6	step 2

Items (DIN reference: DIN right and left hand)

finishes(es)	F1-coloured 124
packing unit	pack of 1
item number	5 400603 0 12401
finishes(es)	stainless steel look 126
packing unit	pack of 1
item number	5 400603 0 12601

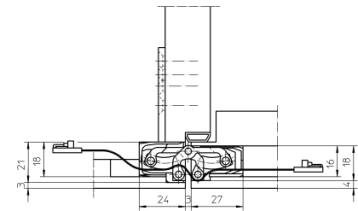

casing frame

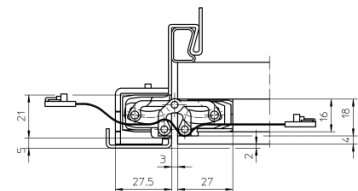

steel frame